

ETB3301V-5.0-Poles, Screw Terminal, 5.0mm pitch

Features

Mechanical Properties

Parameter:	Description
Connector Type:	Terminal Block
Dimensions:	(Poles * 5.0) x 7.6 x 10.10 mm ± 0.2
Operating Temperature Range:	-40°C~+105°C
Wire Range:	14 - 22 AWG
Cable stripping Length:	5 ~ 6 mm
Rated Torque:	0.29Nm (2.6 Lb. in)
Pitch:	5.0 mm
Poles:	2-24 Poles
Housing:	PBT
Screw:	Steel, Zn plated
Terminal:	Copper Alloy, Sn plated
Cage:	Stainless steel



Typical applications

- Wire to Board
- Board to Wire

Electrical Properties

Parameter:	Description	
Standard:	UL	IEC
Rated Voltage:	300V	250V
Rated Current:	15A	17.5A
Contact Resistance:	20mΩ (Max.)	
Insulation Resistance:	500MΩ / 500V	
Withstanding Voltage:	AC 2000V / 1Min.	

Description

The ETB3301V-5.0-Poles is a screw terminal to be mounted directly on a PCB. The number of Poles can be selected in the P/N.

ETB3301V-5.0-Poles, Screw Terminal, 5.0mm pitch

Dimensions

*unit: mm, N= number of poles

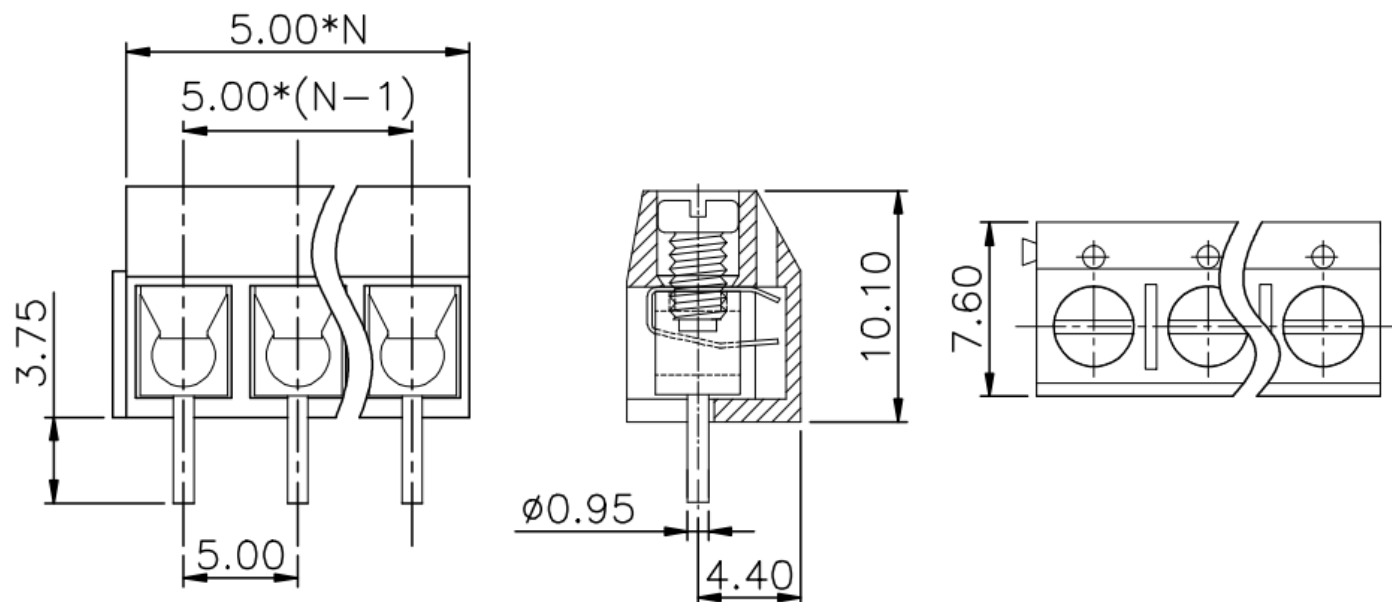

PCB Footprint

*unit: mm , N = number of poles

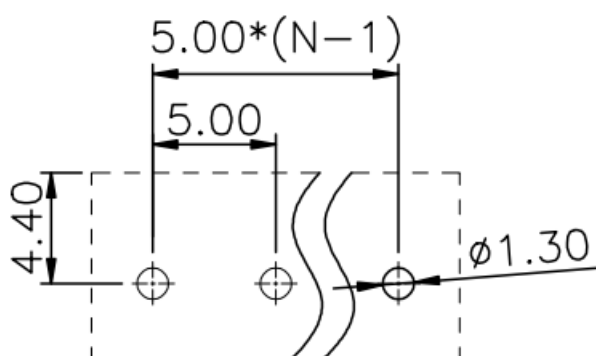

Ordering information

Ordering can be done via www.summit-electronics.com or via info@summit-electronics.com. Please contact us for more information. Customisation of the product is available on request.

Technical support

For all product questions please contact us via info@summit-electronics.com